

“Better By Design”

Industrial Penetrations

TECHNICAL DATA SHEET

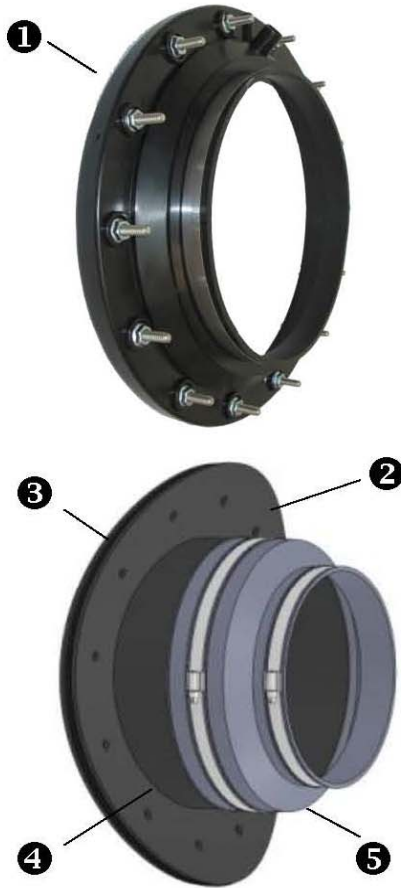

- ❶ Pipe sizes larger than 6” nominal are considered industrial sizes. For 8” pipe, DPM offers two alternatives – a molded penetration similar to Diversified’s traditional studded penetration; and a flanged and bolted penetration as shown in the lower left drawing.
- ❷ The traditional steel welded penetration is available with a flat flange or a flange rolled to a specific diameter for round sumps. For flat configurations, specify ‘-F’ and for curved configurations, specify ‘-C’ with diameter.
- ❸ A compression flange with bolts and nitrile gasket are provided with each unit.
- ❹ Welded steel housing or body.
- ❺ Terminating reducer with band clamps. The terminating reducer normally is polyurethane but may be supplied with other materials. See Industrial Reducer data sheet.

This product has not been submitted to UL for evaluation.

Fits 8”, 10”, 12” or 14”
ANSI Nominal Steel Pipe

	W	X	Y
8	16.6”	7”	8.7”
10	18.6”	7”	10.5”
12	20.4”	7”	12.8”
14	22”	7”	14.0”

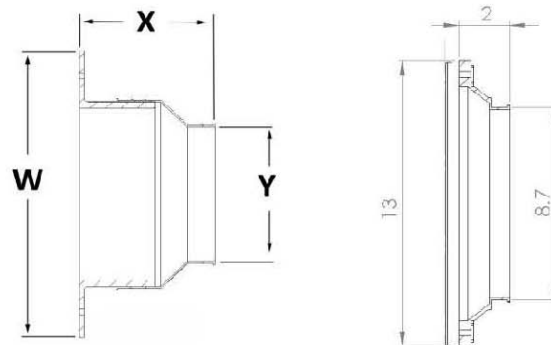

THIRD PARTY APPROVALS



PRODUCTS USED ON THIS PROJECT

	Yes	No		
❶	<input type="checkbox"/>	<input type="checkbox"/>	Studded for 8” Pipe	IN-14S-8.7
❷	<input type="checkbox"/>	<input type="checkbox"/>	Welded for 8” Pipe	IN-B11-8__
❸	<input type="checkbox"/>	<input type="checkbox"/>	Welded for 10” Pipe	IN-B13-10__
❹	<input type="checkbox"/>	<input type="checkbox"/>	Welded for 12” Pipe	IN-B15-12__
❺	<input type="checkbox"/>	<input type="checkbox"/>	Welded for 14” Pipe	IN-B17-14__