



“Better By Design”

Inverted Double Sided Studded Penetration Fittings

TECHNICAL DATA SHEET



Inverted double sided studded penetration fittings include a flexible back plate that seals on flat or curved surfaces, to 24" in diameter. These penetrations are secured with Acetal molded stud nuts on the exterior of the sump. This eliminates having the stainless studs or nuts exposed to the soil. Boot material is UV resistant Alcryn injectible moldable rubber. Assembly includes Series 300 all stainless clamps. Front and back plates are manufactured out of Acetal. Double sided versions include a 'rock guard' on the sump exterior.



1 4 Stud penetrations are available in 3/4" and 1" rigid conduit sizes.



2 8 Stud penetrations are available for 1.5" OD pipes through 3" nominal pipe.

3 10 Stud penetrations are available for 3" nominal pipe through 5.0" OD pipe. 10 Stud penetrations are also used on corrugated chase pipe.



4 12 Stud penetrations are available for 5.2" OD through 6" nominal pipe.

Series 300 stainless clamp, stud seals and external stud nuts provided with each penetration.

Dimensional Data and Product Numbers on Reverse



THIRD PARTY APPROVALS



PRODUCTS USED ON THIS PROJECT

Yes No

- | | | | | |
|---|--------------------------|--------------------------|------------------------------|--------------|
| 1 | <input type="checkbox"/> | <input type="checkbox"/> | 4 Stud Penetration Fittings | PF-4D-_____ |
| 2 | <input type="checkbox"/> | <input type="checkbox"/> | 8 Stud Penetration Fittings | PF-8D-_____ |
| 3 | <input type="checkbox"/> | <input type="checkbox"/> | 10 Stud Penetration Fittings | PF-10D-_____ |
| 4 | <input type="checkbox"/> | <input type="checkbox"/> | 12 Stud Penetration Fittings | PF-12D-_____ |

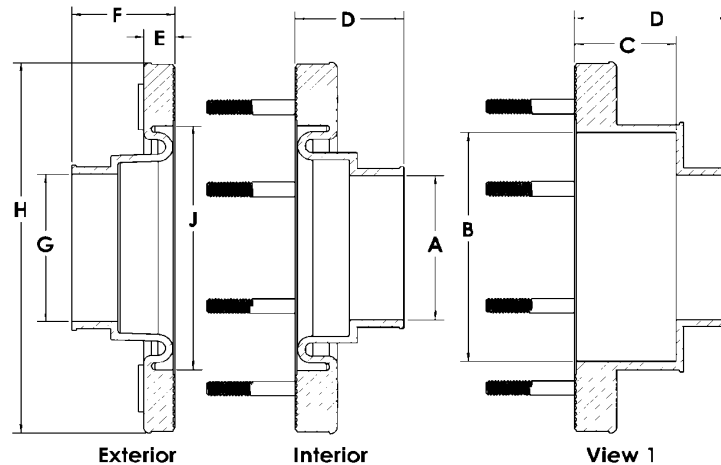

Inverted Double Sided Studded Penetration Dimensional Data

**NOTE:**

41 has one insert that reduces Dim A to 1.2"

419 has two inserts with second insert reducing Dim A to .9"

Part Number	A	B	C	D	E	F	G	H	J
PF-4D-1.1	1.200	N/A	N/A	1.625	0.500	1.625	1.200	4.467	N/A
PF-4D-1.3	1.300	N/A	N/A	1.625	0.500	1.625	1.300	4.467	N/A
PF-4D-1.4	1.390	N/A	N/A	1.625	0.500	1.625	1.390	4.467	N/A
PF-4D-41	1.450/1.100	N/A	N/A	1.625	0.500	1.625	1.450/1.100	4.467	N/A
PF-8D-1.5	1.500	N/A	N/A	1.625	0.500	1.625	1.625	6.375	3.600
PF-8D-1.6	1.625	N/A	N/A	1.625	0.500	1.625	1.625	6.375	3.600
PF-8D-1.7	1.725	N/A	N/A	1.625	0.500	1.625	1.725	6.375	3.600
PF-8D-1.9	1.950	N/A	N/A	1.625	0.500	1.625	1.950	6.375	3.600
PF-8D-2.0	2.050	N/A	N/A	1.625	0.500	1.625	2.050	6.375	3.600
PF-8D-2.2	2.190	N/A	N/A	1.625	0.500	1.625	2.190	6.375	3.600
PF-8D-2.4	2.450	N/A	N/A	1.625	0.500	1.550	2.450	6.375	3.600
PF-8D-2.5	2.550	N/A	N/A	1.625	0.500	1.750	2.550	6.375	3.600
PF-8D-2.7	2.725	N/A	N/A	1.625	0.500	1.750	2.725	6.375	3.600
PF-8D-2.9	2.900	N/A	N/A	1.625	0.500	1.750	2.900	6.375	3.600
PF-8D-3.0	3.030	N/A	N/A	1.625	0.500	1.750	3.030	6.375	3.600
PF-8D-3.3	3.300	N/A	N/A	1.625	0.500	1.750	3.300	6.375	3.600
PF-8D-3.6	3.600	N/A	N/A	1.625	0.500	1.800	3.600	6.375	3.600
PF-10D-3.6	3.600	N/A	N/A	1.660	0.500	1.698	3.600	8.000	4.800
PF-10D-3.8	3.800	N/A	N/A	1.660	0.500	1.698	3.800	8.000	4.800
PF-10D-4.4	4.380	N/A	N/A	1.660	0.500	1.698	4.380	8.000	4.800
PF-10D-4.5	4.550	N/A	N/A	1.660	0.500	1.698	4.550	8.000	4.800
PF-10D-4.6x2.0	2.050	4.650	1.640	2.380	0.500	1.698	4.800	8.000	4.800
PF-10D-4.6x2.5	2.550	4.650	1.640	2.380	0.500	1.698	4.800	8.000	4.800
PF-10D-4.8	4.780	N/A	N/A	1.660	0.500	1.698	4.780	8.000	4.800
PF-10D-5.0	5.050	N/A	N/A	1.660	0.500	1.698	5.050	8.000	4.800
PF-12D-5.2	5.168	N/A	N/A	1.780	0.500	2.150	5.168	9.250	6.675
PF-12D-6.3	6.350	N/A	N/A	1.780	0.500	2.150	6.350	9.250	6.675
PF-12D-6.7	6.675	N/A	N/A	1.780	0.500	2.000	6.675	9.250	6.675

Amount of DBB V or DEB Needed for Coverage	
4 Stud Penetration Fitting	26 ml
8 Stud Penetration Fitting	40 ml
10 Stud Penetration Fitting	48 ml
12 Stud Penetration Fitting	56 ml

Center to Center Diameter of External Plate Stud Holes	
4 Stud	3.28
8 Stud	5.28
10 Stud	6.87
12 Stud	8.06

Hole Saw	
4 Stud	2 1/4"
8 Stud	4"
10 Stud	5 1/2"
12 Stud	6 7/8"